HOGGI[®]



ZIP Service instructions

en

ZIP - Service and maintenance instructions

Content	Seite
1 Model identification & basic configuration	
1.1 Model identification (label)	4
1.2 Basic configuration	4
2 Overview ZIP	5
3 Common information	6
3.1 Preface	6
3.2 Application	6
3.3 Declaration of conformity	6
3.4 Terms of warranty	6
3.5 Customer service	7
3.6 Service and repairs	7
3.7 Packing and shipping instructions	7
4 Safety Instructions	8
4.1 Meaning of symbols	8
4.2 Common safety instructions	8
5 Required tools and maintenance schedule	9
5.1 Required tools	9
5.2 Maintenance schedule	10-11
6 Seat settings	12
6.1 Seat width	12
6.2 Seat depth	12
6.3 Back height	13
6.4 Recline	13
6.5 Footrest angle	14
7 Maintenance schedule	14
7.1 Front strut	14
7.2 Rear frame and axle	14
7.3 Push handles	15
7.4 Seat and seat frame	15
7.5 Back surface and base	15
7.6 Individual upholstery system	16
7.7 Footrest holder & footrest	16
7.8 Front wheels	16
7.9 Swivel lock	17
7.10 Rear wheels	17

7.11	Braking system	18
7.12	Tie down kit	18
7.13	Abduction block	19
7.14	Grab rail	19
7.15	Therapy tray	19
7.16	Belt fixations	20-21
7.17	Winter warmer	21
7.18	Canopy	21
8	Operating life	22
9	Specifications	22

1.1 Model identification

The **label** is mounted on the center strut of the back construction or on the outer, left rear frame strut.

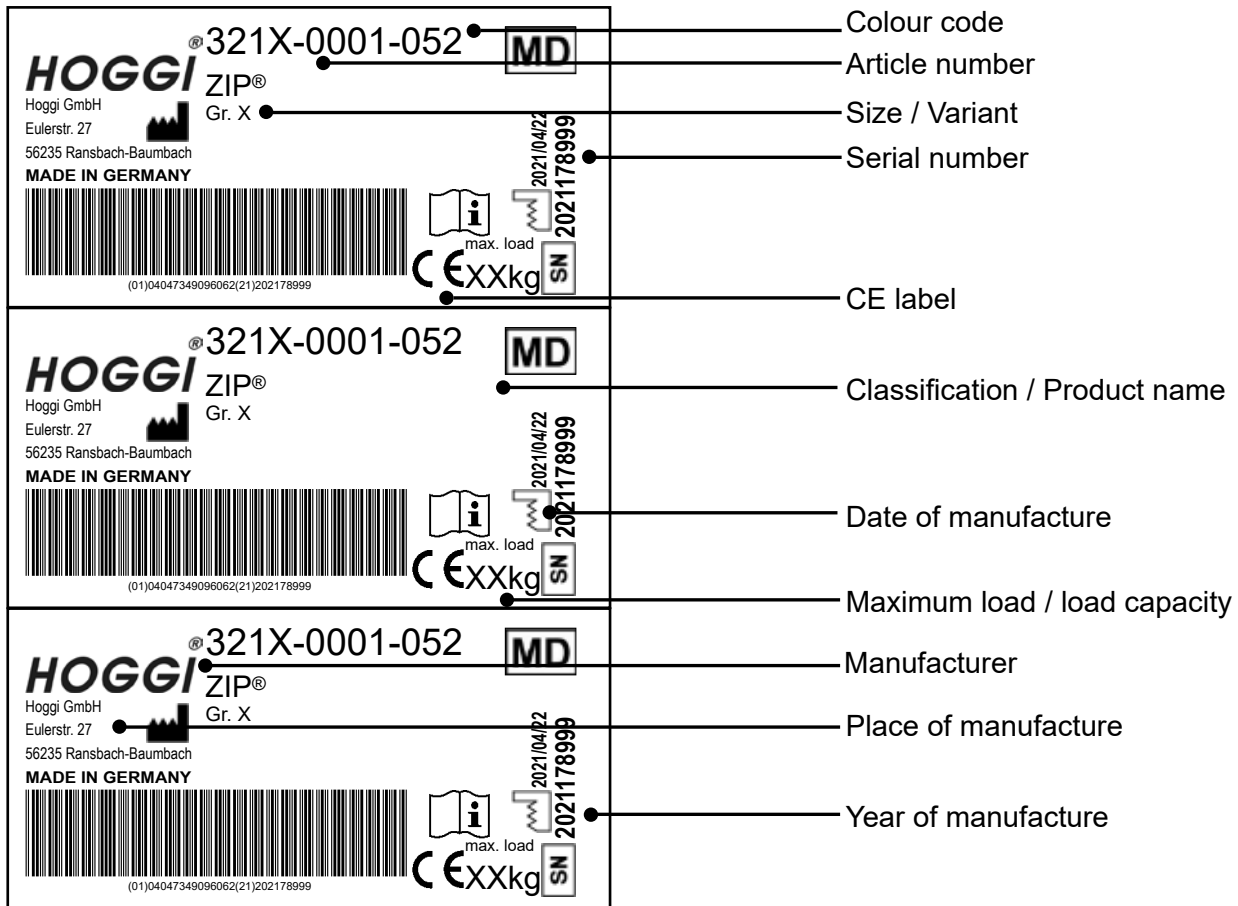

1.2 Basic configuration

- ZIP rehab buggy
- Reinforced nylon seat and back cover
- Stepless, height and angle adjustable and fold-away footrest
- Ball bearing PU or pneumatic tires
- Parking brake

2 Overview ZIP

2.1 ZIP

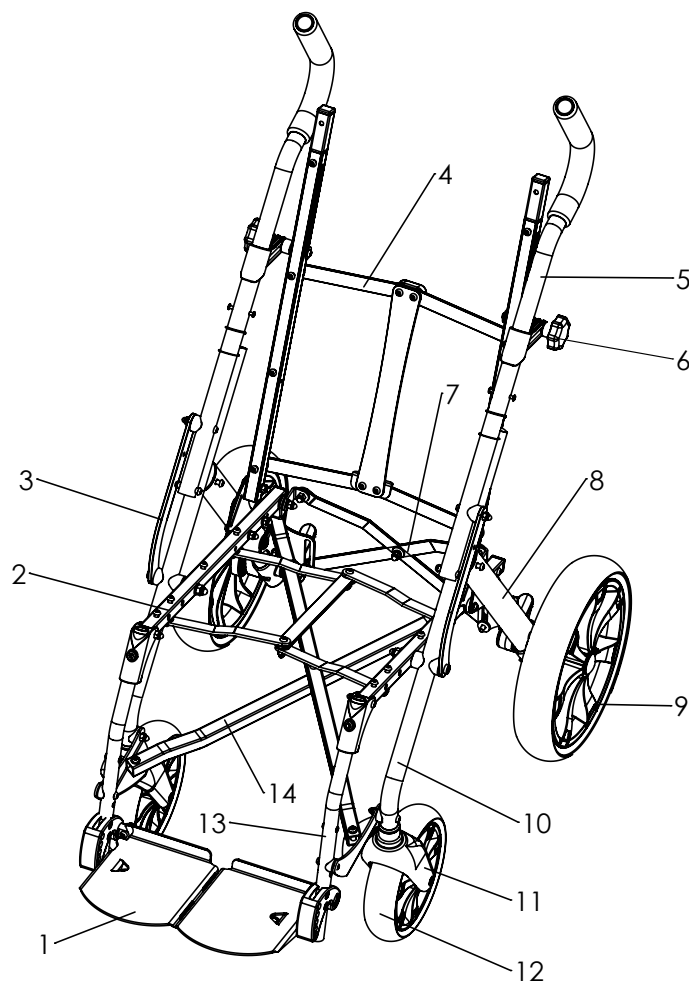

Pos	Artikelnummer	Artikelbezeichnung
1	321X-2310-015	Foot board
2	321X-1700-052	Seat frame
3	3210-1400-052	Support Lever
4	321X-1800-052	Back frame
5	3210-1310-052	Push handle
6	3210-8500	Recline angle extension 5°
7	321X-1240-052	Locking scissors
8	3210-1210-052	Rear strut
9	1221-xxxx	Rear wheels
10	321X-1110-052	Front strut
11	1281-0007E	Castor fork
12	1221-2048	Front wheels
13	321X-2320	Foot board receiver
14	321X-1600-052	Cross strut

3 Common Information

3.1 Preface

Thank you for selecting the **ZIP** rehab pushchair. We have designed this high-quality product to make your life safer and easier, and we've included this manual to help you use and care for it. Please read the following instructions to make sure you use this product as recommended. If you have any further questions, or if you have any problems, please contact your healthcare provider.

We hope that **ZIP** meets your expectations.

We reserve technical modifications regarding the specified model in this manual. Before using the rehab pushchair the first time, this manual has to be read and understood by patient and support personnel in order to ensure a safe handling with the rehab pushchair.

Regular maintenance is important - it increases safety and prolongs the life of the product. Every rehab product should be checked and serviced once a year.

However, it is recommended to check, readjust and, if necessary, service products with a high frequency of use, with users in growth or users with a changing clinical picture at 6-month intervals.

Only original spare parts should be used for all service and maintenance work.

The service and maintenance work described here should only be carried out by trained specialist personnel and not by the user of the aid.

These service and maintenance instructions refer to the respective spare parts catalogues and operating instructions of the products described. Please use all documents together.

Use the maintenance schedule (Chapter 5.2, Checklist to tick off) as a copy template.

Retain completed maintenance schedules and provide a copy to the customer.

ZIP	Manual	1910-0013-DE
ZIP	Spare parts catalogue	1910-1013-DE

3.2 Application

Rehab pushchairs, paediatric postural positioning systems or strollers are appropriate for children and adolescents who are unable to walk or who have a walking impediment and thus requiring mobility assistance.

Assistance may be required due to:

- Atypical muscle tone
- Loss of limbs (dysmelia/lower limb amputation)
- Limb defect and / or deformity
- Joint contractures
- Joint defects
- General weakness

The **ZIP** rehab pushchair is able to be used indoor and outdoor as well as for further service. For further service the product has to be cleaned and sanitised efficiently. Afterwards the product has to be checked concerning condition, wearout and damage by an authorised technician. All

3.3 Declaration of Conformity

HOGGI GmbH as manufacturer declares under sole responsibility that the rehab-pushchair for kids and adolescents **ZIP** meets the general safety and performance requirements to Annex I of the Regulation (EU) 2017/745 of the European Parliament and of the Council. Harmonised European Standards have been applied. Applicable harmonized standards have been applied. **ZIP** meets the requirements of ISO 7176-8, DIN EN ISO 12182 and DIN EN ISO 12183.

3.4 Terms of Warranty

Warranty applies only when the product is used according to the specified conditions and for the intended purposes, following all manufacturer's recommendations. The manufacturer is not responsible for damages caused by components and spare parts not approved by the manufacturer. See also § 8 of terms and conditions on: www.hoggi.de

3.5 Customer service

Our customer service will be happy to answer any technical questions you may have.
Please refer to the last page for contact addresses and telephone numbers.

3.6 Service and repairs

Service and repairs on the **ZIP** rehab pushchair may only be carried out by your specialist dealer. In case of problems, contact your responsible specialist dealer. In case of repairs, you will only receive original spare parts there. Spare parts and replacement units are available during the entire service life of the product, but only for a maximum of 2 years after the sale of the last product in this series.

The rehab pushchair is custom made for the first time user. Therefore, no replacement rehab pushchair is available in the initial configuration. In order to ensure a correct spare parts delivery the serial no. of your rehab pushchair is required. We are happy to help you find a dealer near you.
You can reach us at: **info@hoggi.de**

3.7 Packing and shipping instructions

If **ZIP** has to be sent back to the manufacturer for repair or exchange the product must be thoroughly cleaned/disinfected beforehand and put in a hygienically safe condition.
Packaging is done by wrapping the product in a clean film, ideally with air cushions and the subsequent use of a sufficiently large cardboard box, so that no transport damage can occur.

4 Safety instructions

4.1 Meaning of symbols



Caution!
Warning of possible danger of accident and injury. Warning of possible technical damage.



Information!
About use of product.



Information!
For service-personnel.



Attention!
Read manual before use!

4.2 Common safety instructions

For all maintenance and repair work, you should generally observe a few points:



Attention!
Familiarize yourself with the functions of the product. If you are not familiar with the product, study the user manual before testing. If no user manuals are available, request them from us. You can also download documents from our homepage at: www.hoggi.de



Attention!
Study the service and maintenance instructions before starting work.



Attention!
Use suitable tools (see page 9 ff.).



Attention!
Wear suitable clothing and, if necessary, gloves and protective goggles.



Attention!
Secure the product from tipping over or falling down, e.g. from the workbench.



Attention!
Clean / disinfect the product before starting the test. If necessary, observe the instructions in the user manual and product-specific test instructions.



Note!
Screws and nuts with thread locking are used for a large number of screw connections. If you have to open such screw connections, replace the respective nut or screw with one with new thread locking. If new nuts or bolts with thread locking are not available, use liquid thread locking compound with medium strength (e.g. Loctite 241 or Euro Lock A24.20).

5 Required tools and maintenance schedule

5.1 Required tools

The following list shows the tools and utilities required for service.



Reversible ratchet and sockets
size 8-24



Torque wrench
Measuring ranges 5-50 Nm



Wrench
Size 6 - 24



Hexagon wrench
Gr. 3 - 6



Screwdriver
Blade width 2.5 3.5 and 5.5



Phillips screwdriver
Size 2



Plastic hammer



Hammer approx. 300 g



Carpet knife with sickle and
standard blade



Side cutter



Liquid thread locking
„medium strength



Riveting pliers for rivets up to
5 mm

5.2 Maintenance schedule		ZIP Basic product		Customer:	
Pos.	Area	Check (Checklist to tick off <input checked="" type="checkbox"/>)			
	Serial number:	1.) Function / Setting (see manual)	2.) none damage / deforma- tion	3.) Screw connections	
Mobility base					
1.1	Front frame		<input type="checkbox"/>	<input type="checkbox"/>	<input type="checkbox"/>
1.2	Rear frame and axle	- Parking brake	<input type="checkbox"/>	<input type="checkbox"/>	<input type="checkbox"/>
1.3	Push handles	- Folding mechanism	<input type="checkbox"/>	<input type="checkbox"/>	<input type="checkbox"/>
		- Locking	<input type="checkbox"/>	<input type="checkbox"/>	<input type="checkbox"/>
1.4	Seat and back bearing	- Recline	<input type="checkbox"/>	<input type="checkbox"/>	<input type="checkbox"/>
		- Seat depth adjustment	<input type="checkbox"/>	<input type="checkbox"/>	<input type="checkbox"/>
1.5	Seat surface and seat frame	- Seat depth adjustment	<input type="checkbox"/>	<input type="checkbox"/>	<input type="checkbox"/>
		- Checking nylon seat surface for cracks and bolting	<input type="checkbox"/>	<input type="checkbox"/>	<input type="checkbox"/>
1.6	Back nylon	- Recline	<input type="checkbox"/>	<input type="checkbox"/>	<input type="checkbox"/>
		- Checking for cracks and bolting	<input type="checkbox"/>	<input type="checkbox"/>	<input type="checkbox"/>
1.7	Individual upholstery system	- Damage	<input type="checkbox"/>	<input type="checkbox"/>	
1.8	Footrest system	- Angle adjustment	<input type="checkbox"/>	<input type="checkbox"/>	<input type="checkbox"/>
		- Height adjustment	<input type="checkbox"/>	<input type="checkbox"/>	<input type="checkbox"/>
		- Footrest angle	<input type="checkbox"/>	<input type="checkbox"/>	<input type="checkbox"/>
		- Locking device (optional)	<input type="checkbox"/>	<input type="checkbox"/>	<input type="checkbox"/>
1.9	Front wheels	- Tires	<input type="checkbox"/>	<input type="checkbox"/>	<input type="checkbox"/>
		- Air pressure	<input type="checkbox"/>		
		- Running behavior of the wheels	<input type="checkbox"/>		
		- Swiveling the wheel forks	<input type="checkbox"/>		
1.10	Swivel lock	- Locking device	<input type="checkbox"/>	<input type="checkbox"/>	<input type="checkbox"/>
		- Straight run	<input type="checkbox"/>	<input type="checkbox"/>	<input type="checkbox"/>
1.11	Rear wheels	- Tires	<input type="checkbox"/>	<input type="checkbox"/>	<input type="checkbox"/>
		- Air pressure	<input type="checkbox"/>		
		- Running behavior of the wheels	<input type="checkbox"/>		
		- Quick release	<input type="checkbox"/>		
1.12	Braking system	- Brakes	<input type="checkbox"/>	<input type="checkbox"/>	<input type="checkbox"/>
	Do the settings on the base frame meet the user's requirements?		<input type="checkbox"/>		
Notes:					

5.2 Maintenance schedule		ZIP Accessories		Customer:	
Pos.	Area	Check (Checklist to tick off <input checked="" type="checkbox"/>)			
	Serial number:	1.) Function / setting (see manual)	2.) none damage / deforma- tion	3.) Screw connections	
Accessories					
2.1	Tie down kit	- Damage	<input type="checkbox"/>	<input type="checkbox"/>	<input type="checkbox"/>
2.2	Abduction block (accessories)			<input type="checkbox"/>	<input type="checkbox"/>
2.3	Retainer for accessories		<input type="checkbox"/>	<input type="checkbox"/>	<input type="checkbox"/>
2.4	Grab rail (accessories)	- Locking (tripod springs)	<input type="checkbox"/>	<input type="checkbox"/>	<input type="checkbox"/>
2.5	Therapy tray (accessories)	- Locking (tripod springs) - Angle adjustment - Depth adjustment	<input type="checkbox"/> <input type="checkbox"/> <input type="checkbox"/>	<input type="checkbox"/>	<input type="checkbox"/>
2.6	Belt fixings: Lap belt, five-point harness, foot belts, ankle huger, groin strap, fixation jacket, chest-shoulder pad	- Closures	<input type="checkbox"/>	<input type="checkbox"/>	<input type="checkbox"/>
2.7	Winter warmer	- Damage	<input type="checkbox"/>	<input type="checkbox"/>	
2.8	Canopies (accessories)	- Angle adjustment of canopy - Plug connection to the adapter	<input type="checkbox"/> <input type="checkbox"/>	<input type="checkbox"/>	<input type="checkbox"/>
	Do the seat unit settings meet the user's requirements?		<input type="checkbox"/>		
Notes:					
The maintenance was performed by: on:					



6. Seat settings

6.1 Seat width

The seat width is fixed for ZIP.
The following seat widths result for the two sizes:

Size 1: 35 cm
Size 2: 40 cm



6.2 Seat depth

ZIP offers a decent ability to grow along with the seat depth.
The following adjustment ranges apply to the two sizes:

Size 1: 30 or 35 cm
Size 2: 35 or 40 cm

Measuring point from front edge of seat upholstery to lower edge of back upholstery.



To adjust the seat depth, a total of 8 screws must be loosened.
These are located on the underside where the seat cover is screwed to the side struts.



First, the front screws are loosened.



Then loosen the rear screw connections. Reposition all screws on both sides by one hole to the front or to the rear. Then tighten the screw connections again!



Then loosen the rear screw connections. Reposition all screws on both sides by one hole to the front or to the rear. Then tighten the screw connections again!

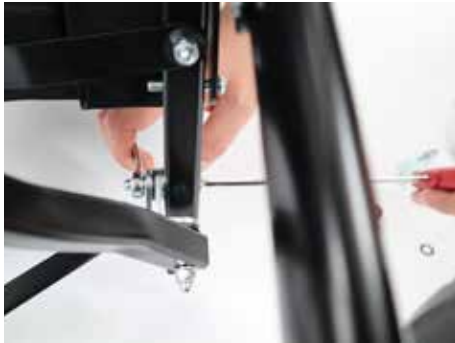

Then loosen the rear screw connections. Reposition all screws on both sides by one hole to the front or to the rear. Then tighten the screw connections again!



The illustration shows the greatest seat depth.



6.3 Back height

Depending on the size, BINGO Evolution offers different back heights.

Size 1: 60 cm / 66 cm (lang)
Size 2: 68 cm



6.4 Recline

The back angle of ZIP can be adjusted between 90° and 100° for size 1 or 95° and 105° for size 2 in relation to the seat surface.



The back angle of ZIP can be adjusted between 90° and 100° for size 1 or 95° and 105° for size 2 in relation to the seat surface.



6.5 Footrest angle

The footrest angle is preset to 90°. The adjustment range is +/- 10° (80° / 90° / 100°).



Pull the release rope in the direction of the footrest edge so that the the locking bolts are pulled inwards.
Swivel the footrest to one of the possible angles and let the locking bolts snap the locking bolts into place.
As the clamp can be rotated, the locking positions in the clamp are doubled.



7. Maintenance schedule

7.1 Front frame

- Check for general damage, bending
- Check of the screw connections to the support bracket



7.2 Rear frame and axle

Check for general damage

- Check for general damage
- Brake function of the parking brake and hold of the brake pedal
- Check of the folding mechanism and the screw connection
- Check of the screw connections to the slider and connector
- Check of the folding struts for bending



7.3 Push handles

- Check for general damage
- Folding in via the release button



- Latching of the push handles in unfolded state, bolt must release from the lock when folded and lock again when unfolded.

Check of the screw connections:

- Lower screw connection of the push handle lower parts to the slider
- Fastening of the trigger
- Rivet connection of the trigger



7.4 Seat surface and seat frame

- Check for general damage
- Check of the folding struts underneath the seat surface



- Check of the screw connections from the seat upholstery to the seat frame.
- Checking riveted joints or attached brackets for straps, if any.



7.5 Back surface and base

Back cover (front)

- Check for general damage
- Check the bolting to the frame
- Check folding struts and folding lever



Back cover (rear side)

- Check for general damage
- Check the bolting to the frame
- Check folding struts and folding lever



7.6 Individual upholstery system

- Check for general damage or impurities
- Wear of the upholstered surfaces



7.7 Footrest holder & Footrest

Standard

Functional test:

- Height adjustment
- Check for general damage
- Correct adjustment of the foot angle
- Check tension bolt and fine wire rope



Check of the screw connections:

- Screw connection to the footrest with correct angle adjustment
- Screws for lower leg length adjustment
- Screwing of the swivel mechanism



7.8 Front wheels

- Plastic or aluminum steering fork
- Check for general damage
- Check of the tread or profile (cracks, heavy wear)
- Impurities
- Check of the air pressure of pneumatic tires



- Camber of the wheel worn too much



Check of the bolted connections:

- Screw connection of the wheel axle
- Bolting of the steering fork axle to the frame



Make sure that the steering fork is set up as follows!

The sealing washer with the O-ring prevents excessive „fluttering“ of the steering forks.
The screw must be tightened accordingly with 40 Nm!



7.12 Swivel lock

- Check for general damage
- Check of the latch
- Check of the straight run



7.10 Rear wheels

- Air or PU tires
- Check for general damage (storage)
- Running behavior of the wheels
- Check of the treads and the luddt pressure (if pneumatic tires)
- Check of the quick locks



7.11 Braking system

ZIP can be equipped with 2 brake variants!

Parking brake:

- Basic configuration
- Not in combination with drum brake wheels
- Easily replaceable
- Locking when locked?
- Pivoting



Brake for attendant

- Check for general damage
- Check of the brake levers
- Check of the Bowden cable

- Check of the screw connection of the brake levers to the push bar



- Build-up of the brake pressure (readjustment of the adjusting screw)



Wheel with aluminum brake disc

- Check of the holes (knocked out, broken bars)
- Impurities



7.12 Tie down kit

Front securing eyelets:

- Check for general damage (deformation, sharp edges).
edges)

- Check of the screw connections to the frame and to the edge skid



Rear securing eyelets:

- Check of the screw connections to the frame



7.13 Abduction block

Functional test:

- Check for general damage
- Pivoting and latching mechanism
- Removal

Check of the screw connections:

- Bracket abduction block to the seat panel



7.14 Grab rail

Functional test:

- Check for general damage
- Damage to the cover
- Check of the tripod springs and the anchoring in the retainer for accessories

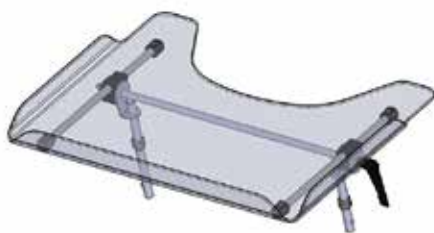

7.15 Therapy tray

Standart

Functional test:

- Check for general damage
- Damage of angle adjustment and depth adjustment
- Check of the tripod springs and the anchoring in the retainer for accessories

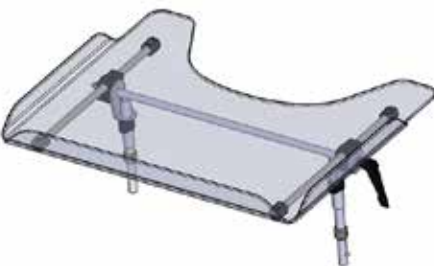

Height adjustable

Functional test:

- Check for general damage
- Damage of angle adjustment and depth adjustment
- Height adjustment
- Check of the tripod springs and the anchoring in the retainer for accessories



7.16 Belt fixations

Lap belt

Functional test:

- Check for general damage
- Check of the fastener
- Check of the screw connection of the bracket



4-point lap belt

Functional test:

- Check for general damage
- Check of the fastener
- Check of the screw connection of the bracket



Ankle hugger

Functional test:

- Check for general damage
- Check of the fastener
- Check of the screw connection of the bracket to the footrest



Five-point harness

Functional test:

- Check for general damage
- Check of the fastener
- Check of the screw connection of the brackets



Groin strap

Functional test:

- Check for general damage
- Check of the fastener
- Check of the screw connection of the brackets



Fixation jacket

Functional test:

- Check for general damage
- Check of the fastener
- Check of the screw connection of the brackets
- Function of the buckles on the back panel
- Rivet connection of the clamping buckles



Chest-shoulder harness

Functional test:

- Check for general damage
- Check of the fastener
- Check of the screw connection of the brackets
- Function of the buckles on the back panel
- Rivet connection of the clamping buckles



7.17 Winter warmer

Functional test:

- Check for general damage
- Zipper intact
- Damage to the real fur insert if present



7.18 Canopy

Functional test:

- Check for general damage
- Folding and unfolding of the canopy



- Removal via canopy adapter
- Checking the screw connections of the adapter to the back bar

8. ZIP operating life:

The expected operating life of the **ZIP** is 5 years, depending on the intensity of use, care as well as maintenance. We recommend an annual inspection by the authorized specialist dealer. In case of malfunctions or defects of the wheelchair, it must be immediately handed over to the medical supply store or the specialist dealer.

9 Specifications

	ZIP Size 1	ZIP Size 2
Seat width	350 mm	400 mm
Seat depth	250 / 300 / 350 mm	350 / 400 mm
Seat angle	18°	18°
Back height	600 mm / 660 mm	680 mm
Recline	90° - 100°	95° - 105°
Lower leg length	200 - 390 mm	250 - 440 mm
Rear wheel diameter	300 x 60 mm	300 x 60 mm
Steering wheel diameter	200 x 50 mm	200 x 50 mm
Static stability: to the front / to the rear / to the side	max. 14° / max. 24° / max. 19°	max. 14° / max. 24° / max. 19°
Minimum turning circle	1260 mm	1400 mm
User weight / Maximum load*	50 kg	50 kg
Weight**	12,5 kg	13,5 kg
Height when folded	390 mm	400 mm
Total length Maximum	780 mm	910 mm
Total width Maximum	590 mm	650 mm
Height	1010 mm	1010 mm
Weight of the heaviest part (seat unit)	12,5 kg	13,5 kg

**CAUTION!**

*Accessories and add-on parts reduce the remaining load capacity for the occupant.

**CAUTION!**

The weight specifications refer to a **ZIP in basic equipment.

HOGGI GmbH
Eulerstraße 27 • 56235 Ransbach-Baumbach • Deutschland
Telefon: (+49) 2623 / 92 499-0
E-mail: info@hoggi.de • www.hoggi.de